

Ovalflaschen

Oval bottles | Flacons ovales



OVALFLASCHEN | Oval bottles | Flacons ovales

DIMENSIONEN | Dimensions | Dimensions

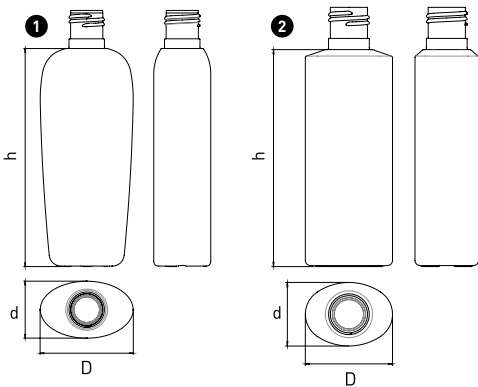

D/d = MAX. DURCHMESSER | Max. diameter | Diamètre max.
h = GESAMTHÖHE OHNE VERSCHLUSS-SYSTEM |
 Overall height without sealing cap | Hauteur totale sans capot

MATERIAL | Material | Matière

FLASCHE | Bottle | Flacon: **PE**
SCHRAUBKAPPE | Screw cap | Capot à vis: **PP**
SPRITZEINSATZ | Plug | Reducteur: **PE-LD**

INDIVIDUELLE DEKORATION

Einfärbung, Druck, Prägung, Lackierung und Metallisierung.

CUSTOMIZATION

Coloured material, printing, hot foil stamping, lacquering and metallization.

DÉCORATION PERSONNALISÉE

Sérigraphie, gravure, marquage à chaud, laquage et métallisation.

TECHNISCHE DATEN | Technical details | Spécifications techniques

| NENNVOLUMEN Volume Volume ml | FLASCHE Bottle Flacon | | | VERSCHLUSS Cap Couvercle | | | SPRITZEINSATZ Plug Reducteur | DICHTTEINLAGE Liner Joint | DICHTLIPPE Sealing rim Lèvre d'étanchéité | PUMPE Pump Doseur | AUF-/ZU-VERSCHLUSS Open/close cap Capsule service | SCHRAUBKAPPE Screw Cap Capot à vis | STECKKAPPE Protective cap Capot encliquetable | DIMENSIONEN Dimensions Dimensions (mm) | |
|--------------------------------------|---------------------------|---------------------------------|---|------------------------------|---------------------------------|---------------------------------|-------------------------------------|----------------------------------|--|--------------------------|--|---|--|---|-----|
| | NR. No. N° | MATERIAL Material Matière | NORMGEWINDE Standard thread Filetage standard | SERIE Series Série | MATERIAL Material Matière | OBERFLÄCHE Surface Aspect | | | | | | | | D/d | h |
| | | | | | GLATT smooth lisse | MATT matt mat | | | | | | | | | |
| 1 30 | 0382 | PE | | | | | | | • | | | • | | 34/22 | 78 |
| 1 200 | 0381 | PE | GCM1 24/415 | | | | | | | • | | • | | 63/40 | 146 |
| 2 150 | 0264 | PE | GCM1 24/415 | | | | | | | • | | • | | 52/38 | 126 |
| | 0269 | PE | GCM1 24/410 | | | | | | | • | | • | | 52/38 | 126 |

DIMENSIONEN | Dimensions | Dimensions

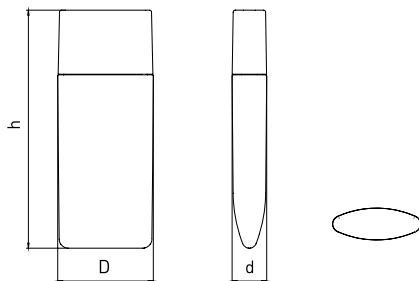

D/d = MAX. DURCHMESSER | max. diameter | Diamètre max.
h = GESAMTHÖHE | overall height | Hauteur totale

MATERIAL | Material | Matière

TUBE | Tottle | Flacon tube: **PE**
SCHRAUBKAPPE | Screw cap | Capot à vis: **PP**
SPRITZEINSATZ | Plug | Reducteur: **PP**
STECKKAPPE | Protective cap | Capot encliquetable: **PP**

TUBENFLASCHEN | Tottles | Flacon tube

TECHNISCHE DATEN | Technical details | Spécifications techniques

| | | | | | | | | | | | | | | | |
|----|------|----|--|--|----|---|--|---|--|--|--|---|--|-------|-----|
| 30 | 0282 | PE | | | PP | • | | • | | | | • | | 48/18 | 117 |
| 40 | 0294 | PE | | | PP | • | | • | | | | • | | 48/18 | 128 |
| 50 | 0262 | PE | | | PP | • | | • | | | | • | | 53/20 | 129 |

OVALFLASCHEN | Oval bottles | Flacons ovales

DIMENSIONEN | Dimensions | Dimensions

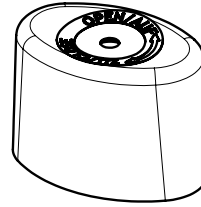
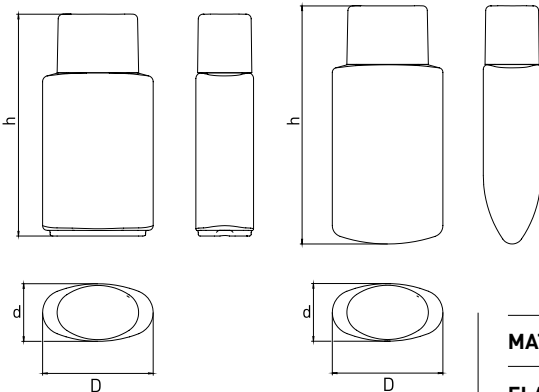

AUF-/ZU-VERSCHLUSS |
Open/close cap | Capsule service

D/d = MAX. DURCHMESSER | Max. diameter | Diamètre max.
h = GESAMTHÖHE | Overall height | Hauteur totale

MATERIAL | Material | Matière

FLASCHE | Bottle | Flacon: **PE**
SCHRAUBKAPPE | Screw cap | Capot à vis: **PP, PP/PP**
SPRITZEINSATZ | Plug | Reducteur: **PE-LD**

INDIVIDUELLE DEKORATION

Einfärbung, Druck, Prägung, Lackierung und Metallisierung.

CUSTOMIZATION

Coloured material, printing, hot foil stamping, lacquering and metallization.

DÉCORATION PERSONNALISÉE

Sérigraphie, gravure, marquage à chaud, laquage et métallisation.

TECHNISCHE DATEN | Technical details | Spécifications techniques

| NENNVOLUMEN Volume Volume ml | FLASCHE Bottle Flacon | | | SCHRAUBVERSCHLUSS Cap Couvercle | | | SPRITZEINSATZ Plug Reducteur | DICHTEINLAGE Liner Joint | DICHTLIPPE Sealing rim Lèvre d'étanchéité | SCHRAUBKAPPE Screw Cap Capot à vis | AUF-/ZU-VERSCHLUSS Open/close cap Capsule service | DIMENSIONEN Dimensions Dimensions (mm) | | |
|--------------------------------------|---------------------------|---------------------------------|---|-------------------------------------|---------------------------------|---------------------------------|-------------------------------------|---------------------------------|--|---|--|---|-----|---------------------|
| | NR. No. N° | MATERIAL Material Matière | NORMGEWINDE Standard thread Filetage standard | SERIE Series Série | MATERIAL Material Matière | OBERFLÄCHE Surface Aspect | | | | | | D/d | h | |
| | | | | | | GLATT smooth lisse | | | | | | | | MATT matt mat |
| 75 | 0411 | PE | | EURO | PP/PE-LD | • | | | | • | | 53/32 | 105 | |
| | | | | EURO | PP/PP | • | • | • | | • | | 53/32 | 105 | |
| 100 | 0306 | PE | | EURO | PP/PE-LD | • | | | | • | | 59/30 | 118 | |
| | | | | EURO | PP/PP | • | • | • | | • | | 59/30 | 118 | |
| 150 | 0359 | PE | | EURO | PP/PE-LD | • | | | | • | | 66/34 | 136 | |
| | | | | EURO | PP/PP | • | • | • | | • | | 66/34 | 136 | |
| 200 | 0307 | PE | | EURO | PP/PE-LD | • | | | | • | | 73/38 | 146 | |
| | | | | EURO | PP/PP | • | • | • | | • | | 73/38 | 146 | |
| 250 | 0313 | PE | | EURO | PP/PE-LD | • | | | | • | | 78/40 | 154 | |
| | | | | EURO | PP/PP | • | • | • | | • | | 78/40 | 154 | |
| | 0332 | PE | | EURO | PP/PE-LD | • | | | | • | | 78/40 | 154 | |
| | | | | EURO | PP/PP | • | • | • | | • | | 78/40 | 154 | |

TUBENFLASCHEN | Tottles | Flacon tube

TECHNISCHE DATEN | Technical details | Spécifications techniques

| | | | | | | | | | | | | | |
|-----|------|----|--|------|----------|---|---|---|--|---|--|-------|-----|
| 100 | 0333 | PE | | EURO | PP/PE-LD | • | | | | • | | 60/30 | 127 |
| | | | | EURO | PP/PP | • | • | • | | • | | 60/30 | 127 |
| 150 | 0408 | PE | | EURO | PP/PE-LD | • | | | | • | | 67/35 | 141 |
| | | | | EURO | PP/PP | • | • | • | | • | | 67/35 | 141 |

hopf

www.hopf.de

Interesse? Fragen? Wir sind gerne für Sie da!

Hopf Packaging GmbH

Wemdinger Str. 13 | D-86720 Nördlingen
(Besucher-Anfahrt über Reutheweg)

Telefon +49 9081-806-0

Telefax +49 9081-806
-200 Vertrieb
-203 Versand
-271 Einkauf

E-Mail info@hopf.de

Web www.hopf.de

QR-Code scannen &
Website besuchen!

